

凡例	記号	境界標の種類	記号	境界標の種類	記号	境界標の種類
	石	石杭	金	金属杭	キ	刻み
	コ	コンクリート杭	ブ	プレート	計	計算点
	合	合成杭	紙	金属紙		

地番 871-1, 871-5乃至871-16  
 土地の所在 高崎市金古町字庚申

地積測量図

求積表

地番	① 871-1				
NO	Xn	Yn	Yn+1-Yn-1	Xn · (Yn+1-Yn-1)	
K8	45431.269	-75436.584	23.373	1061865.050337	
2	45421.013	-75425.926	-1.326	-60228.263238	
P2	45408.564	-75437.910	-23.373	-1061334.366372	
P1	45418.331	-75449.299	1.326	60224.706906	
			合計	527.127633	
			合計面積	263.5638165	
			地積	263.56	m <sup>2</sup>

地番	② 871-5				
NO	Xn	Yn	Yn+1-Yn-1	Xn · (Yn+1-Yn-1)	
P4	45393.351	-75460.019	-5.026	-228146.982126	
P3	45390.022	-75455.729	16.180	734410.555960	
19	45402.404	-75443.839	17.819	809025.436876	
P2	45408.564	-75437.910	-5.460	-247930.759440	
P1	45418.331	-75449.299	-15.176	-689268.591256	
K4	45414.477	-75453.086	-8.974	-407549.516598	
P6	45408.923	-75458.273	2.383	108209.463509	
P5	45403.052	-75450.703	-1.746	-79273.728792	
			合計	-524.121867	
			合計面積	262.0609335	
			地積	262.06	m <sup>2</sup>

地番	③ 871-6				
NO	Xn	Yn	Yn+1-Yn-1	Xn · (Yn+1-Yn-1)	
P9	45405.076	-75475.125	7.735	351208.262860	
P4	45393.351	-75460.019	24.422	1108596.418122	
P5	45403.052	-75450.703	1.746	79273.728792	
P6	45408.923	-75458.273	-9.363	-425163.746049	
P7	45407.003	-75460.066	-9.481	-430503.795443	
P8	45412.969	-75467.754	-15.059	-683873.900171	
			合計	-463.031889	
			合計面積	231.5159445	
			地積	231.51	m <sup>2</sup>

地番	④ 871-7				
NO	Xn	Yn	Yn+1-Yn-1	Xn · (Yn+1-Yn-1)	
P10	45409.386	-75480.678	-8.664	-393426.920304	
P9	45405.076	-75475.125	12.924	586815.202224	
P8	45412.969	-75467.754	15.059	683873.900171	
P7	45407.003	-75460.066	9.481	430503.795443	
P6	45408.923	-75458.273	6.980	316954.282540	
K4	45414.477	-75453.086	-7.928	-360045.973656	
KB9	45424.392	-75466.201	-13.375	-607551.243000	
P11	45424.609	-75466.461	-14.477	-657612.064493	
			合計	-489.021075	
			合計面積	244.5105375	
			地積	244.51	m <sup>2</sup>

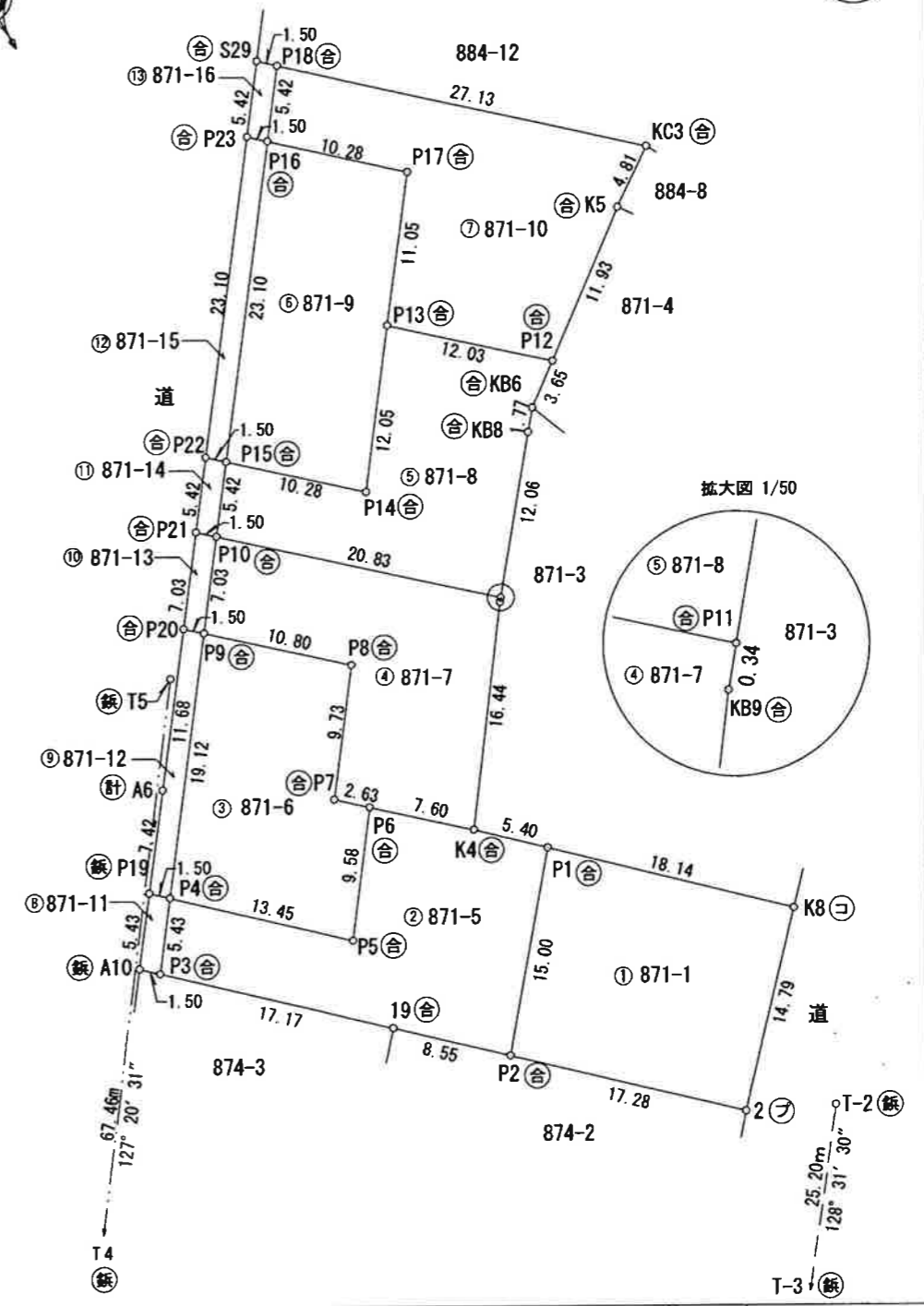
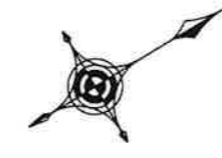

作成者 高崎市上中居町43番地1  
 土地家屋調査士 須長 亮 (令和4年12月16日作成)

申請人 [Redacted]

縮尺 1/500

地番 871-1, 871-5乃至871-16 地積測量図

土地の所在 高崎市金古町字庚申

2/2

Table for land parcel 871-8 with columns: NO, Xn, Yn, Yn+1-Yn-1, Xn · (Yn+1-Yn-1). Includes summary rows for total area and ground area.

Table for land parcel 871-9 with columns: NO, Xn, Yn, Yn+1-Yn-1, Xn · (Yn+1-Yn-1). Includes summary rows for total area and ground area.

Table for land parcel 871-10 with columns: NO, Xn, Yn, Yn+1-Yn-1, Xn · (Yn+1-Yn-1). Includes summary rows for total area and ground area.

Table for land parcel 871-11 with columns: NO, Xn, Yn, Yn+1-Yn-1, Xn · (Yn+1-Yn-1). Includes summary rows for total area and ground area.

Table for land parcel 871-12 with columns: NO, Xn, Yn, Yn+1-Yn-1, Xn · (Yn+1-Yn-1). Includes summary rows for total area and ground area.

Table for land parcel 871-13 with columns: NO, Xn, Yn, Yn+1-Yn-1, Xn · (Yn+1-Yn-1). Includes summary rows for total area and ground area.

Table for land parcel 871-14 with columns: NO, Xn, Yn, Yn+1-Yn-1, Xn · (Yn+1-Yn-1). Includes summary rows for total area and ground area.

Table for land parcel 871-15 with columns: NO, Xn, Yn, Yn+1-Yn-1, Xn · (Yn+1-Yn-1). Includes summary rows for total area and ground area.

Table for land parcel 871-16 with columns: NO, Xn, Yn, Yn+1-Yn-1, Xn · (Yn+1-Yn-1). Includes summary rows for total area and ground area.

Table with measurement date (令和4年11月4日) and coordinate system (世界測地系).

器械点座標一覧表

Table listing instrument points with columns: 点名, X座標, Y座標.

作成者 高崎市上中居町43番地1 土地家屋調査士 須長 亮 (令和4年12月16日作成)

申請人 [Redacted] 縮尺